

# ECU-02

## Digital Gen-set PLC Control Unit Provides Full Instrumentation & Protection On Any Generator Set

### Features

- Micro-Processor Based Design
- Easy-to-Read Large LED Display
- Compact Size with Vibration Protected
- Provides Full Engine & Generator Alarms Signals & Shut Downs
- 2 Wire Remote Start & Stop
- Front Panel Mounted With Manual, Off & Auto Switch
- Provided With Easy-to-Install Auxiliaries, Relays & Fuses
- No Need for Magnetic Pick-up to Check Over Speed
- Simple Operation & Programming\*
- No Battery Power Needed to Maintain Program\*\*

### 4 Digit 7 Segment Easy-to-Read LED Display

- Programmable Display with 3 Phase Volts, Amp & Freq.
- Failure Alarms Status
- Battery DC Voltage Indicator
- Total Engine Operating Hours & Service Alarm
- Internal Program Settings & Status

### Protection & Alarm Status

- Engine Start Failure
- Engine Over Speed
- MPU Failure
- Abnormal Generator Voltage
- Low Engine Oil Pressure
- Emergency Stop Activated
- High Engine Temperature
- Generator Over Load
- Low Fuel Level
- Low DC Voltage

### Mechanical Specifications

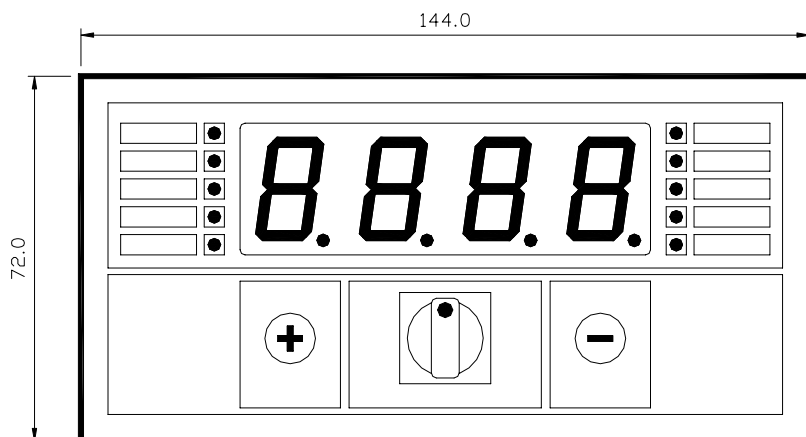

UNIT: mm

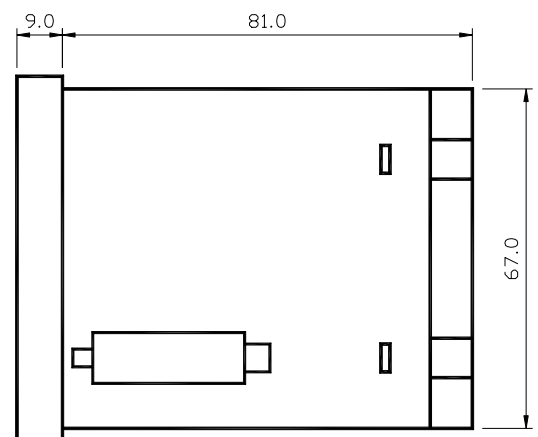

Weight: 372 g ± 2%



\* There is no need for PC connection or software--all operation can be done directly on ECU-02.

\*\* Customized settings are auto-saved into memory and will remain even when power is off.

### Specifications

<b>Power Input</b>	Voltage	9 ~ 30 VDC
<b>Sensing Input</b>	Voltage	15 ~ 380 VAC 3 phase 3 wire
	Frequency	50 ~ 60 Hz
<b>MPU Signal Input</b>	Voltage	±2V to ±70V Peak
	Frequency	Min.100Hz, Max.10KHz
<b>Control Signals</b>	Current	2.5 Amp with input volts
<b>CT Specifications</b>	Burden	2.5VA
	CT Range	Min. 25A/5A, Max 3000A/5A
<b>Power Dissipating</b>		Max. 7 Watt
<b>Operating Temp.</b>		-25 ~ +75 °C

### Auxiliaries

**Easy-to-Install Relay Board** ECU-11(12V) & ECU-22(24V)  
**Isolation Transformer Module** PTU-03

\* Suffix "K"—Indicated a key switch is added..

\* Panel Installation Cut-Out: 137.5±0.5 mm × 67.0±0.5 mm

Please link to [www.mcphersoncontrols.com](http://www.mcphersoncontrols.com) for detailed manual.